



wateroam[®]

ROAMfilter Plus User Guide
Maintenance: Forward Flush

© 2020

BUILDING A WORLD WITHOUT PROLONGED THIRST

Overview

6 maintenance processes to follow for good continued operation:

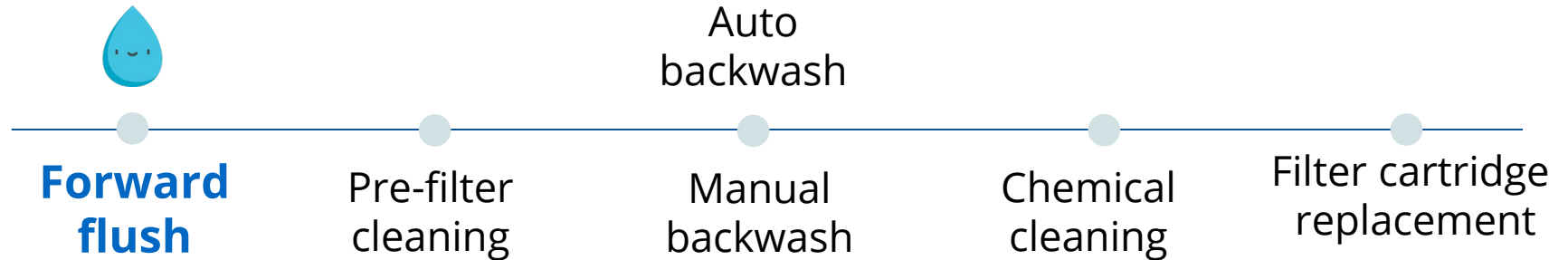

Recommended maintenance frequency:

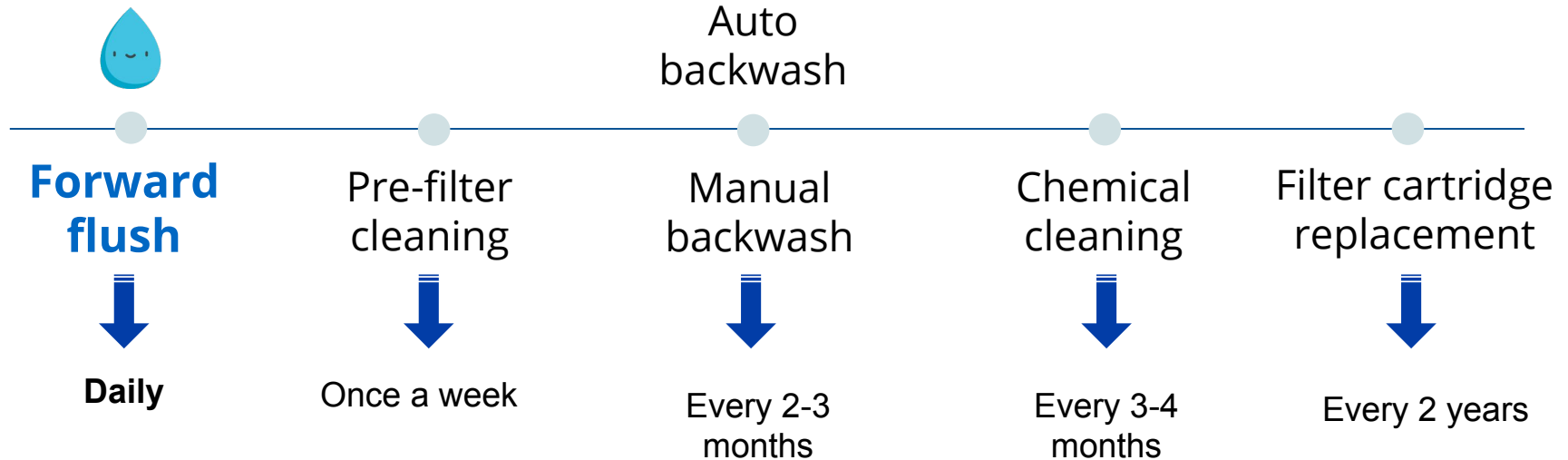

*Disclaimer: product maintenance may vary based on context

Purpose of Forward Flush

- Process of running clean water through the system.
- Prevents silt build-up, maintains high system flow rate and enhances life span of the filter.

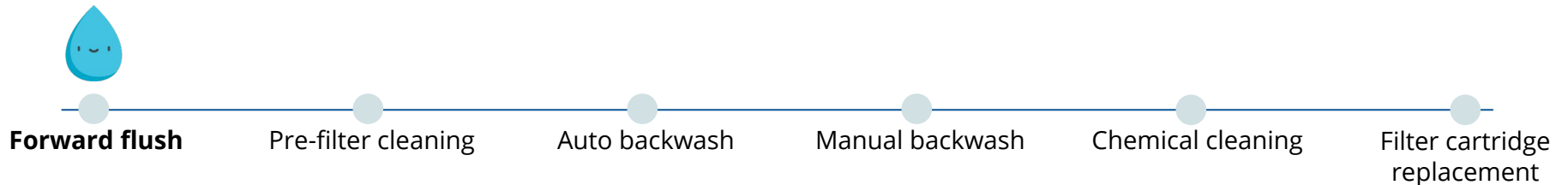

Key Components of the ROAMfilter Plus:

Front View

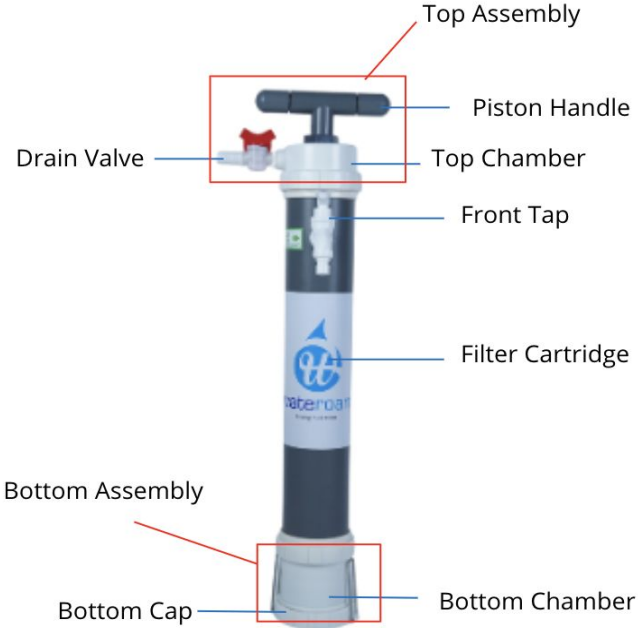

Back View

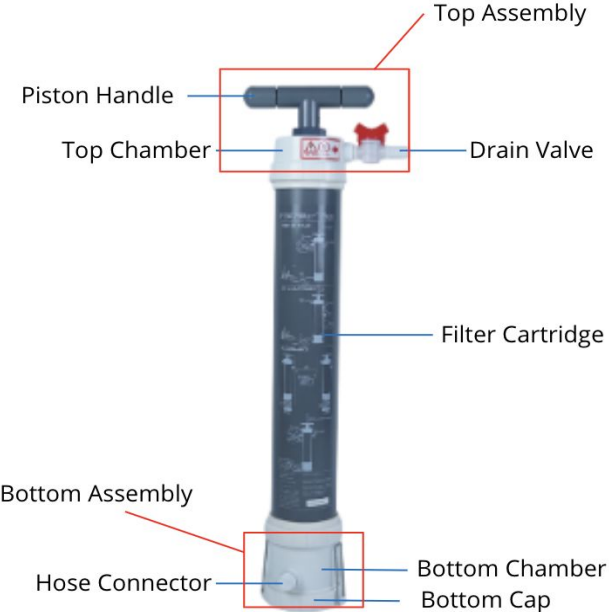

Note: A detailed version can be found in your ROAMfilter Plus Instruction Manual



Key Components of the ROAMfilter Plus:

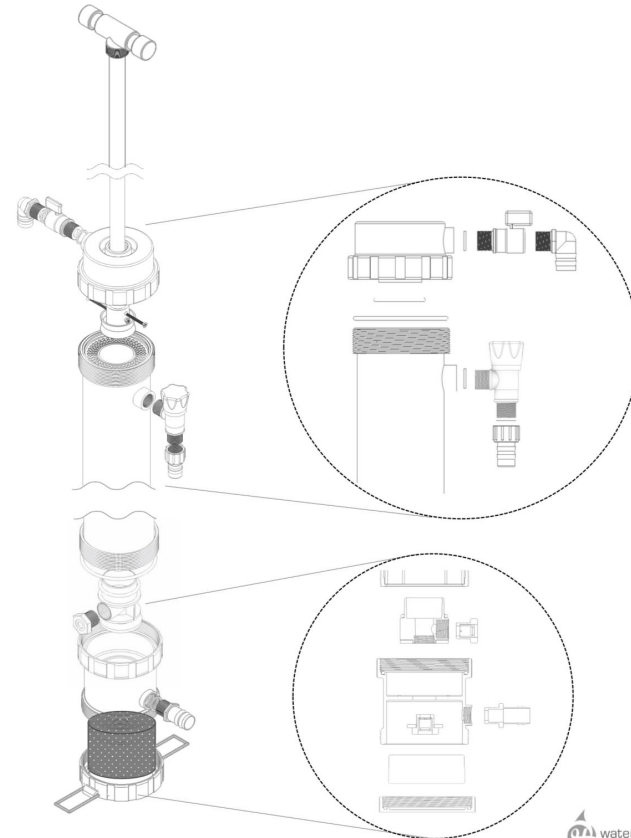
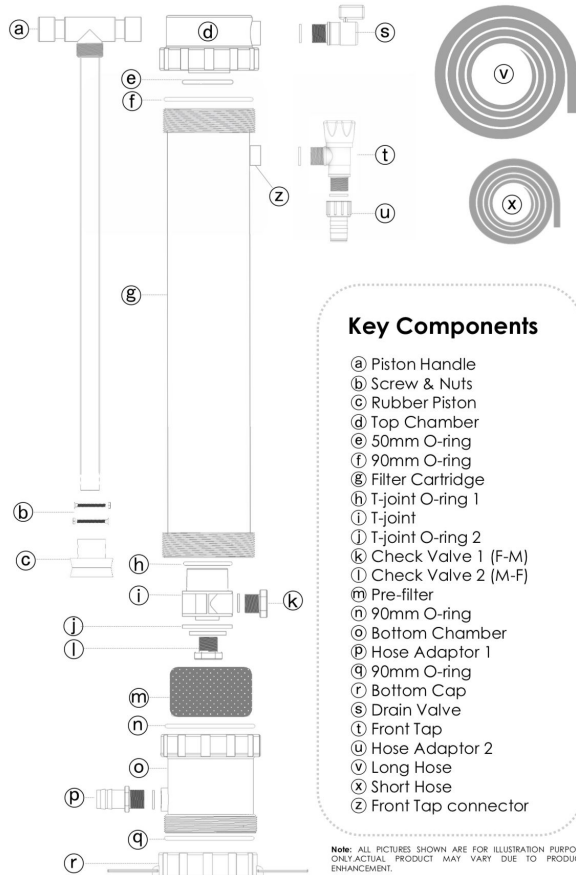

Note: A detailed version of the Key Components can be found in your ROAMfilter Plus Instruction Manual

Video Tutorial: Forward Flush

[Click here for the: ROAMfilter™ Plus Forward Flush video](#)



Forward Flush

Important pointers:

1. Performed **daily**/ whenever required.
2. Ensure Front Tap is closed before opening Drain Valve.

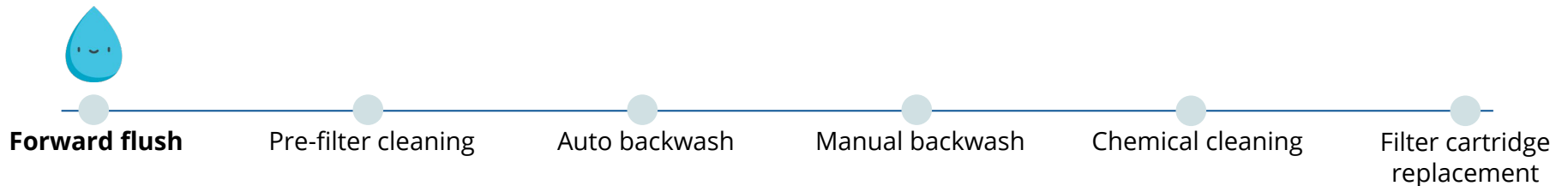

Thank You

Any questions?

Contact details:

Phone number: +65 6303 0603

Email: support@wateroam.com