



**wateroam**<sup>®</sup>

**ROAMfilter Plus User Guide**  
**Troubleshooting: Membrane Integrity**  
**Test**

© 2020

**BUILDING A WORLD WITHOUT PROLONGED THIRST**

# Key Components of the ROAMfilter Plus:

## Front View

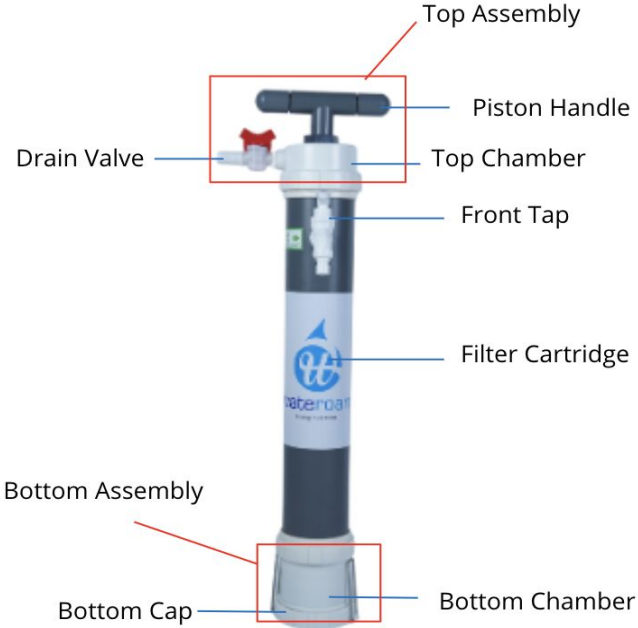

## Back View

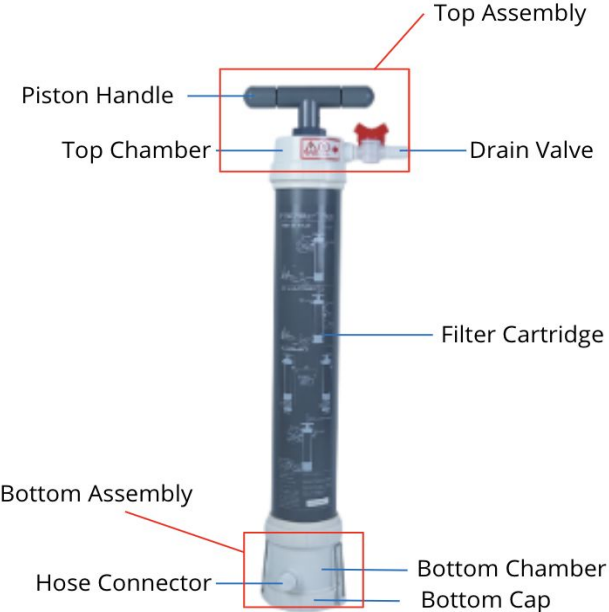

**Note:** A detailed version can be found in your ROAMfilter Plus Instruction Manual



# Key Components of the ROAMfilter Plus:

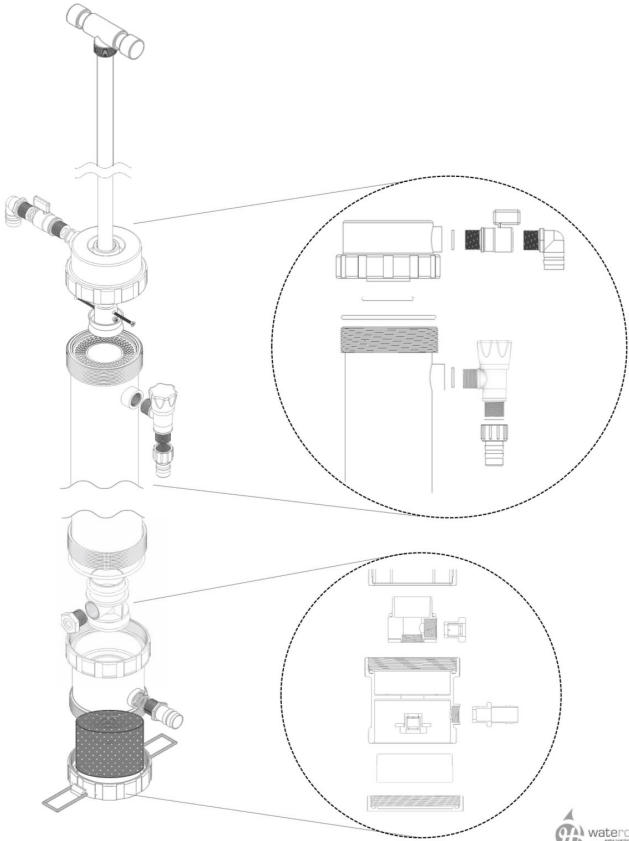
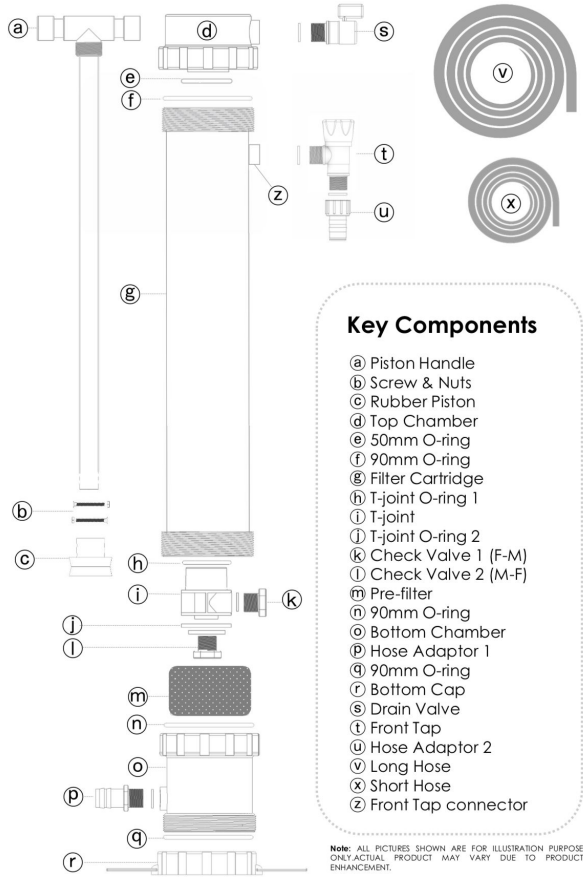

**Note:** A detailed version of the Key Components can be found in your ROAMfilter Plus Instruction Manual

# Purpose of Membrane Integrity Test



- The Membrane Integrity Test is conducted **to evaluate if the ROAMfilter™ Plus membrane is operating in good condition.**
- Cross contamination may occur if the membrane is compromised. **Do not use if the system fails the test.**

# Membrane Integrity Test

## Required materials:



A bucket of clean and pathogen-free water

# Video Tutorial: Membrane Integrity Test



There will be a few large bubbles appearing immediately after the first pump

*Click here for the: [ROAMfilter™ Plus Membrane Integrity Test video](#)*

# Membrane Integrity Test



## Important pointers:

1. Recommended to be performed **once every three months**.
2. Before starting the test, ensure the **membrane is wet** by performing the standard set-up procedure (pumping water into the system).
3. Before conducting the test ensure that the Top Assembly, Bottom Assembly and Drain Valve are **properly tightened**.
4. A **few large bubbles** after the first pump are expected.
5. **Cross contamination** may occur if the membrane is compromised.

# Thank You

**Any questions?**

**Contact details:**

Phone number: +65 6303 0603

Email: [support@wateroam.com](mailto:support@wateroam.com)